



Automotive Equipment

HC5502 HC4502

Electro-hydraulic two post lifts with top connection



Lifts

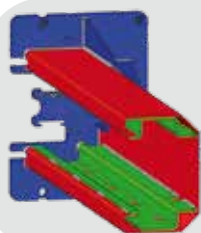

Internally reinforced column structure
for little bending and internal cable guiding



Four **three-section symmetrical** arms

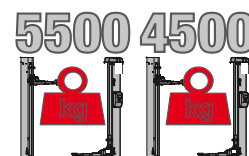

Possibility of installation in symmetrical or asymmetrical version.



Automotive Equipment

HC5502 - HC4502



Realignment of the two carriages using metal cables that guarantee excellent synchronisation.

Standard height of two-post connection: 4,050 mm.

Available versions (with optional column extension set):

- **V:** Specific for vans (Height of two-post connection: 4,620 mm).
- **XV:** Specific for vans and very high vehicles, extra-high version (Height of two-post connection: 5,220 mm).



PROTECTIONS

Rubber door protections.

Toothed sector arm rotation stop system.

SAFETY

Electro magnet safety release **24V**

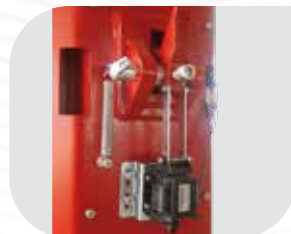

STANDARD ACCESSORIES

- Safety stop-bar included as standard.
- Two set of extension pads h= 80 mm and h= 180 mm.

TECHNICAL DATA

Model	Teco HC4502	Teco HC5502
Lift capacity	4500 kg	5500 kg
Lifting time	45 s	
Three phase motor	400/230V - 3kW - 3Ph - 50/60Hz	
Single phase motor	230V - 3kW - 1Ph - 50/60Hz	
Max. lifting height	2062 mm	
Max. locking position	1957 - 2037 mm	
Lift minimum height	115 mm	
Height connection	4050/4620/5520 mm	

OPTIONAL ACCESSORIES



See separate catalogue for further accessories.

DIMENSIONS

HC4502 Symmetric Installation

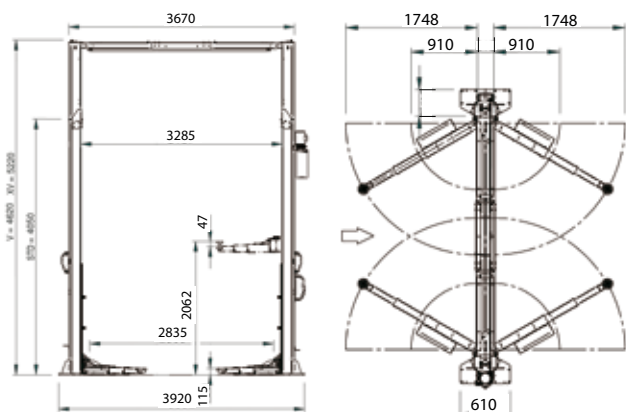

HC5502 Asymmetric Installation

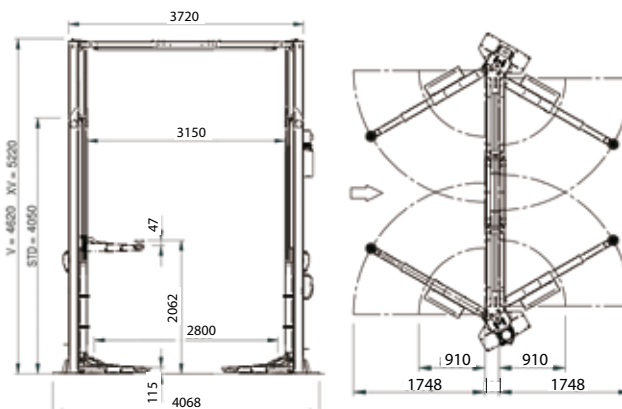

The manufacturer reserves the right to modify the features of its products at any time.

Cod. DPTC000517A_07_2024



NEXION SPA - ITALY -
www.tecoautomotive.com - teco@teco.it

Designed in
ITALY

